

**Ordering number C12480\_MIRELLA-50-S-PIN**

|                 |               |             |            |
|-----------------|---------------|-------------|------------|
| Family          | Mirella       | FWHM        | 11 degrees |
| Type            | Reflector     | Efficiency  | 92 %       |
| LED             | NS9x383       | cd/Im       | 11.800     |
| Color           | Metal         | Gerber File | Available  |
| Diameter        | 49.9 mm       |             |            |
| Height          | 23.9 mm       |             |            |
| Style           | Round         |             |            |
| Optic Material  | PC            |             |            |
| Holder Material | -             |             |            |
| Fastening       | Pin           |             |            |
| Status          | On production |             |            |

Please note that the position pin holes come very close to the L

**Ordering number CN12486\_MIRELLA-50-S-PIN-DL**

|                 |               |             |            |
|-----------------|---------------|-------------|------------|
| Family          | Mirella       | FWHM        | 14 degrees |
| Type            | Pack          | Efficiency  | 85 %       |
| LED             | NS9x383       | cd/Im       | 6.100      |
| Color           | Metal         | Gerber File | Available  |
| Diameter        | 49.9 mm       |             |            |
| Height          | 23.9 mm       |             |            |
| Style           | Round         |             |            |
| Optic Material  | PC            |             |            |
| Holder Material | -             |             |            |
| Fastening       | Pin           |             |            |
| Status          | On production |             |            |

Please note that the position pin holes come very close to the L

**Ordering number C12481\_MIRELLA-50-M-PIN**

|                 |               |             |            |
|-----------------|---------------|-------------|------------|
| Family          | Mirella       | FWHM        | 24 degrees |
| Type            | Reflector     | Efficiency  | 88 %       |
| LED             | NS9x383       | cd/Im       | 2.450      |
| Color           | Metal         | Gerber File | Available  |
| Diameter        | 49.9 mm       |             |            |
| Height          | 23.9 mm       |             |            |
| Style           | Round         |             |            |
| Optic Material  | PC            |             |            |
| Holder Material | -             |             |            |
| Fastening       | Pin           |             |            |
| Status          | On production |             |            |

Please note that the position pin holes come very close to the L

**Ordering number CN12487\_MIRELLA-50-M-PIN-DL**

|                 |               |             |            |
|-----------------|---------------|-------------|------------|
| Family          | Mirella       | FWHM        | 32 degrees |
| Type            | Pack          | Efficiency  | 83 %       |
| LED             | NS9x383       | cd/Im       | 1.700      |
| Color           | Metal         | Gerber File | Available  |
| Diameter        | 49.9 mm       |             |            |
| Height          | 23.9 mm       |             |            |
| Style           | Round         |             |            |
| Optic Material  | PC            |             |            |
| Holder Material | -             |             |            |
| Fastening       | Pin           |             |            |
| Status          | On production |             |            |

Please note that the position pin holes come very close to the L

**Ordering number C12482\_MIRELLA-50-W-PIN**

|                 |               |             |            |
|-----------------|---------------|-------------|------------|
| Family          | Mirella       | FWHM        | 39 degrees |
| Type            | Reflector     | Efficiency  | 89 %       |
| LED             | NS9x383       | cd/Im       | 1.500      |
| Color           | Metal         | Gerber File | Available  |
| Diameter        | 49.9 mm       |             |            |
| Height          | 23.9 mm       |             |            |
| Style           | Round         |             |            |
| Optic Material  | PC            |             |            |
| Holder Material | -             |             |            |
| Fastening       | Pin           |             |            |
| Status          | On production |             |            |

Please note that the position pin holes come very close to the L

**Ordering number CN12488\_MIRELLA-50-W-PIN-DL**

|                 |               |             |            |
|-----------------|---------------|-------------|------------|
| Family          | Mirella       | FWHM        | 46 degrees |
| Type            | Pack          | Efficiency  | 83 %       |
| LED             | NS9x383       | cd/Im       | 1.150      |
| Color           | Metal         | Gerber File | Available  |
| Diameter        | 49.9 mm       |             |            |
| Height          | 23.9 mm       |             |            |
| Style           | Round         |             |            |
| Optic Material  | PC            |             |            |
| Holder Material | -             |             |            |
| Fastening       | Pin           |             |            |
| Status          | On production |             |            |

Please note that the position pin holes come very close to the L

**NOTE: The typical divergence will be changed by different color, chip size and chip position tolerance. The typical total divergence is the full angle measured where the luminous intensity is half of the peak value.**



## PRODUCT DATASHEET

### Mirella series

last update 24/6/2013



#### GENERAL INFORMATION

- Product series especially designed & optimized for NS9x383 series of LEDs.
- Special care taken to make light distribution as uniform as possible.
- Reflector is made of aluminium coated PC (120 degrees of Celcius / 248 degrees of Fahrenheit) with protective lacquer (110 degrees of Celcius / 230 degrees of Fahrenheit).

D

C

B

A

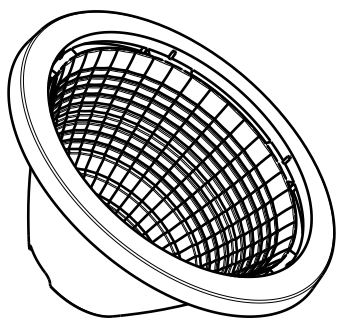

Isometrric view

8.6 C/C

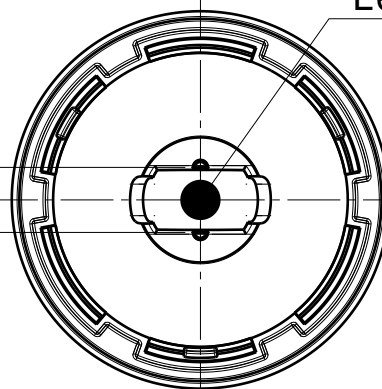

Led position

Botto view

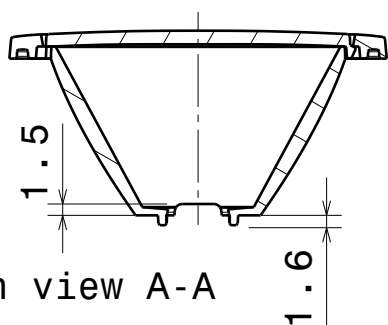

Section view A-A

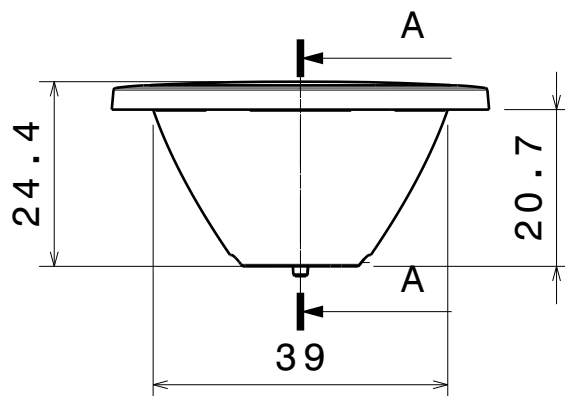

Front view

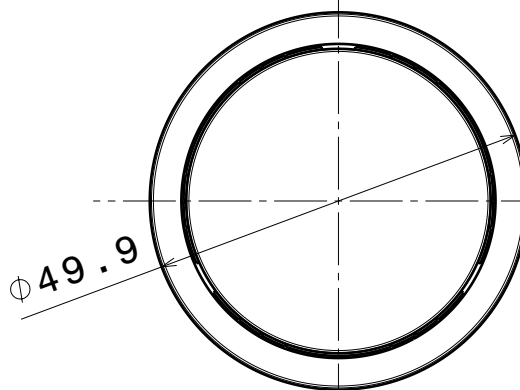

Top view

Tolerances if not otherwise shown  
According to DIN ISO 2768-1  
Linear measures:  
Up to 30mm class F, otherwise class M.  
According to DIN ISO 2768-2  
Form and position: class K

**LEDiL**

Ledil Oy  
Salorankatu 10  
FIN 24240 SALO  
Finland

THIRD ANGLE PROJECTION:

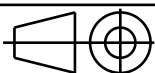

DRAWING TITLE

Datasheet\_Mirella\_pin

This drawing is the property  
of LEDiL Oy. It may not be  
reproduced, copied or  
communicated without a written  
agreement with LEDiL Oy."

SIZE

A4

PART NUMBER

-

SCALE

1:1

WEIGHT

-

SHEET

1/1

D

A

Luminaire: LEDiL Oy C12480\_MIRELLA-50-S-PIN\_(NS9x383) Eff 91,7%  
Lamps: 1 x Nichia NS9x383 (105lm@250mA)

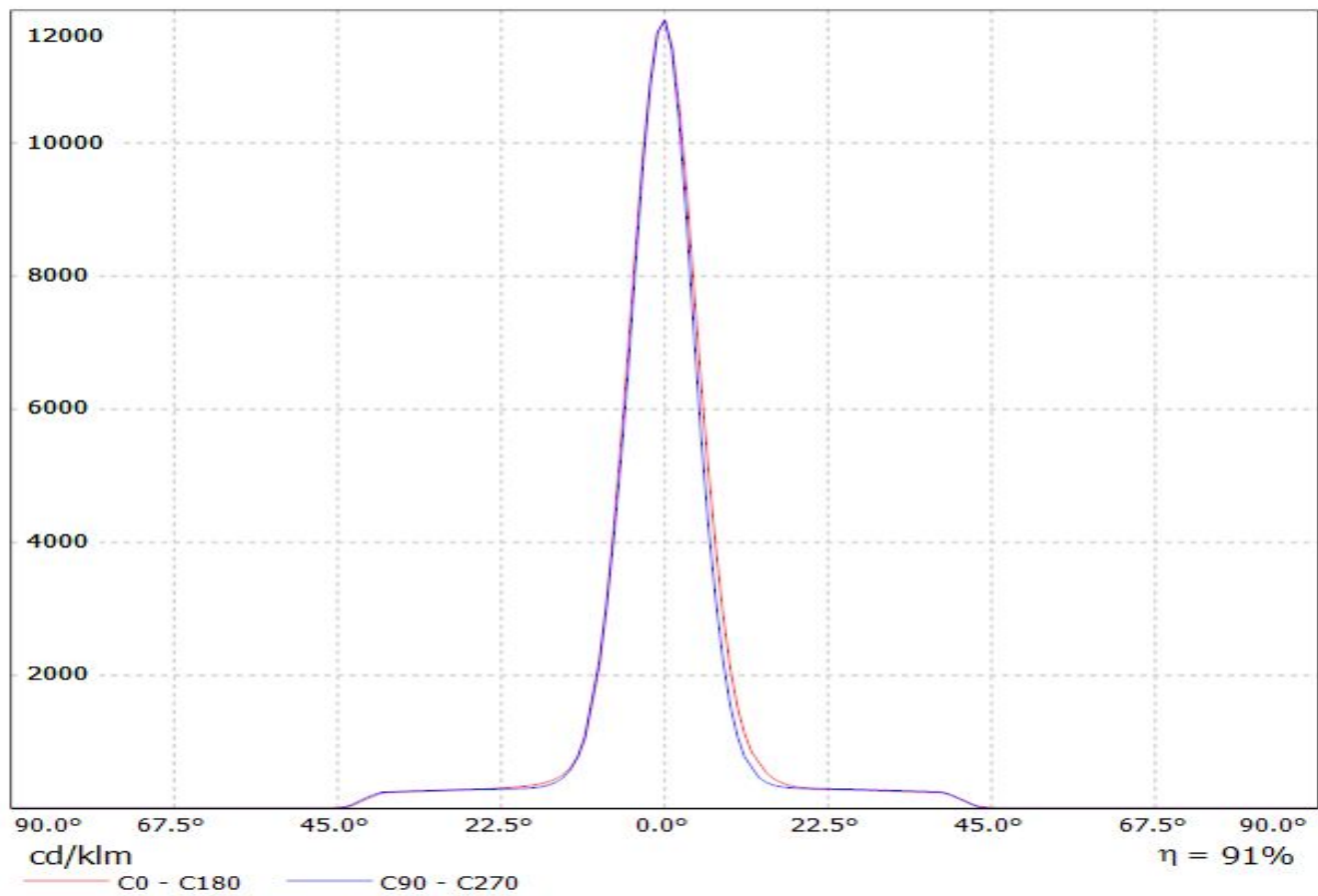

Luminaire: LEDiL Oy CN12486\_MIRELLA-50-S-PIN-DL Eff. 85,1%  
Lamps: 1 x Nichia NS9x383 (105lm@250mA)

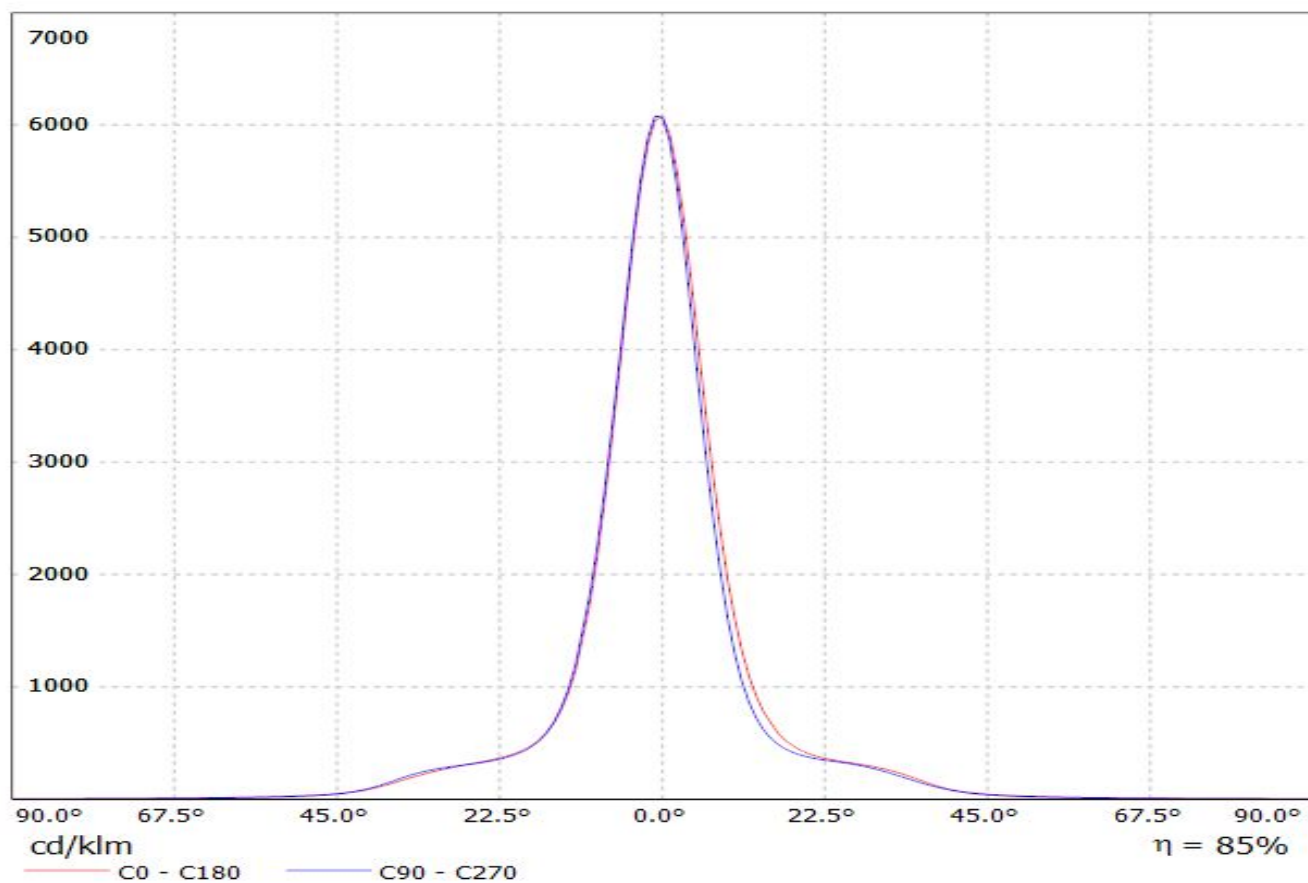

Luminaire: LEDiL Oy C12481\_MIRELLA-50-M-PIN\_(NS9x383) Eff. 88,3%  
Lamps: 1 x Nichia NS9x383 (105lm@250mA)

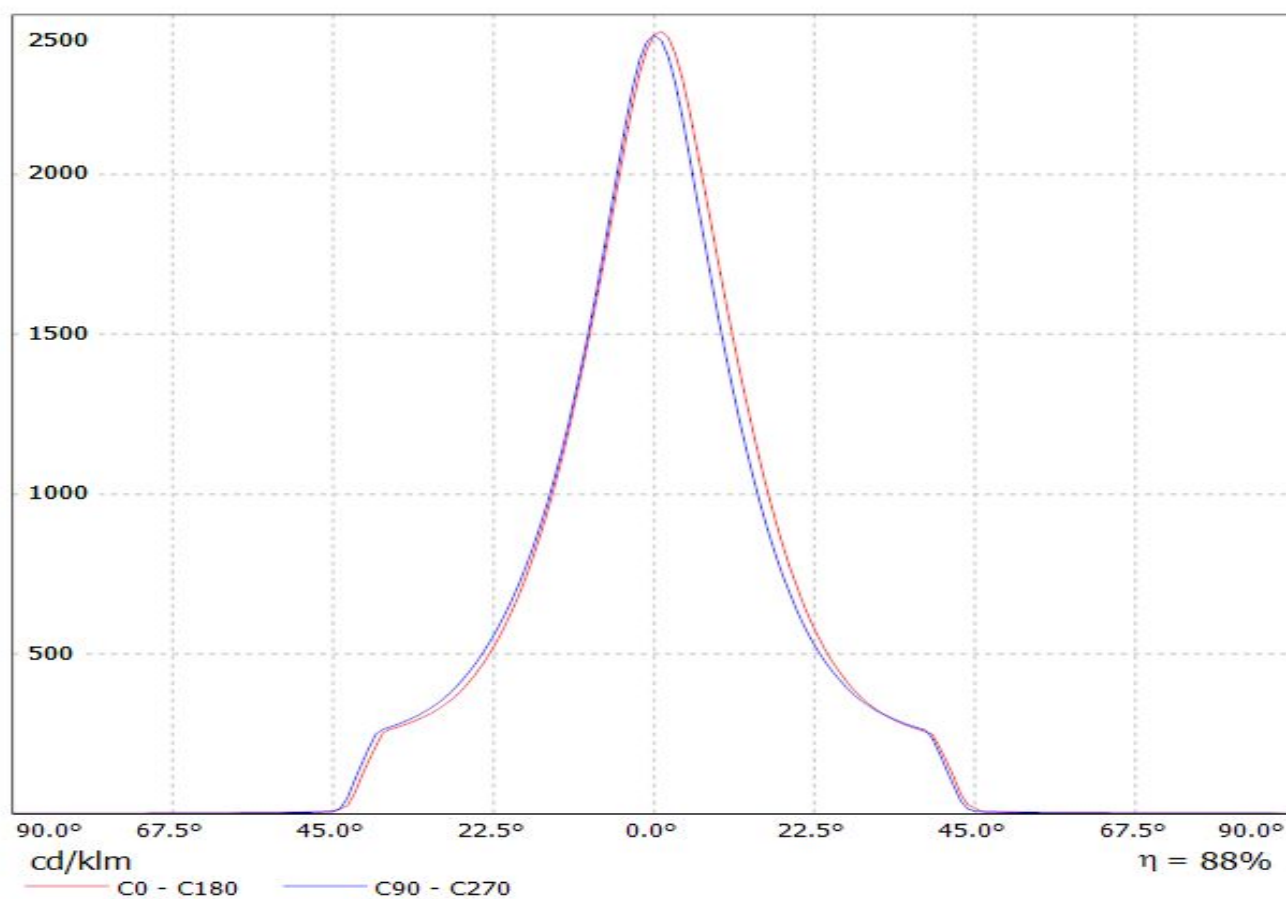

Luminaire: LEDiL Oy CN12487\_MIRELLA-50-M-PIN-DL\_(NS9x383) Eff. 82,5%  
Lamps: 1 x Nichia NS9x383 (105lm@250mA)

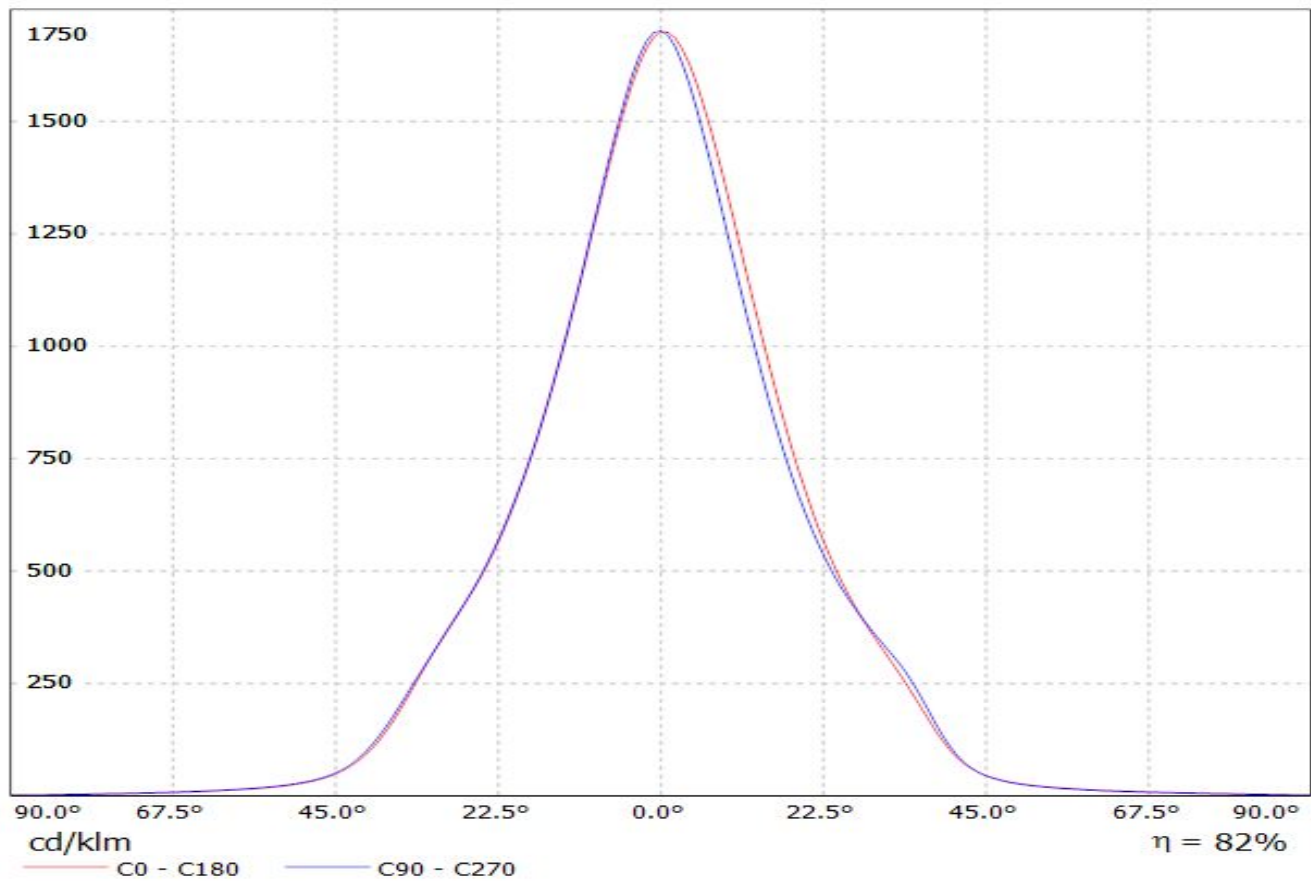



Luminaire: LEDiL Oy C12482\_MIRELLA-50-W-PIN\_(NS9x383) Eff. 88,5%  
Lamps: 1 x Nichia NS9x383 (105lm@250mA)

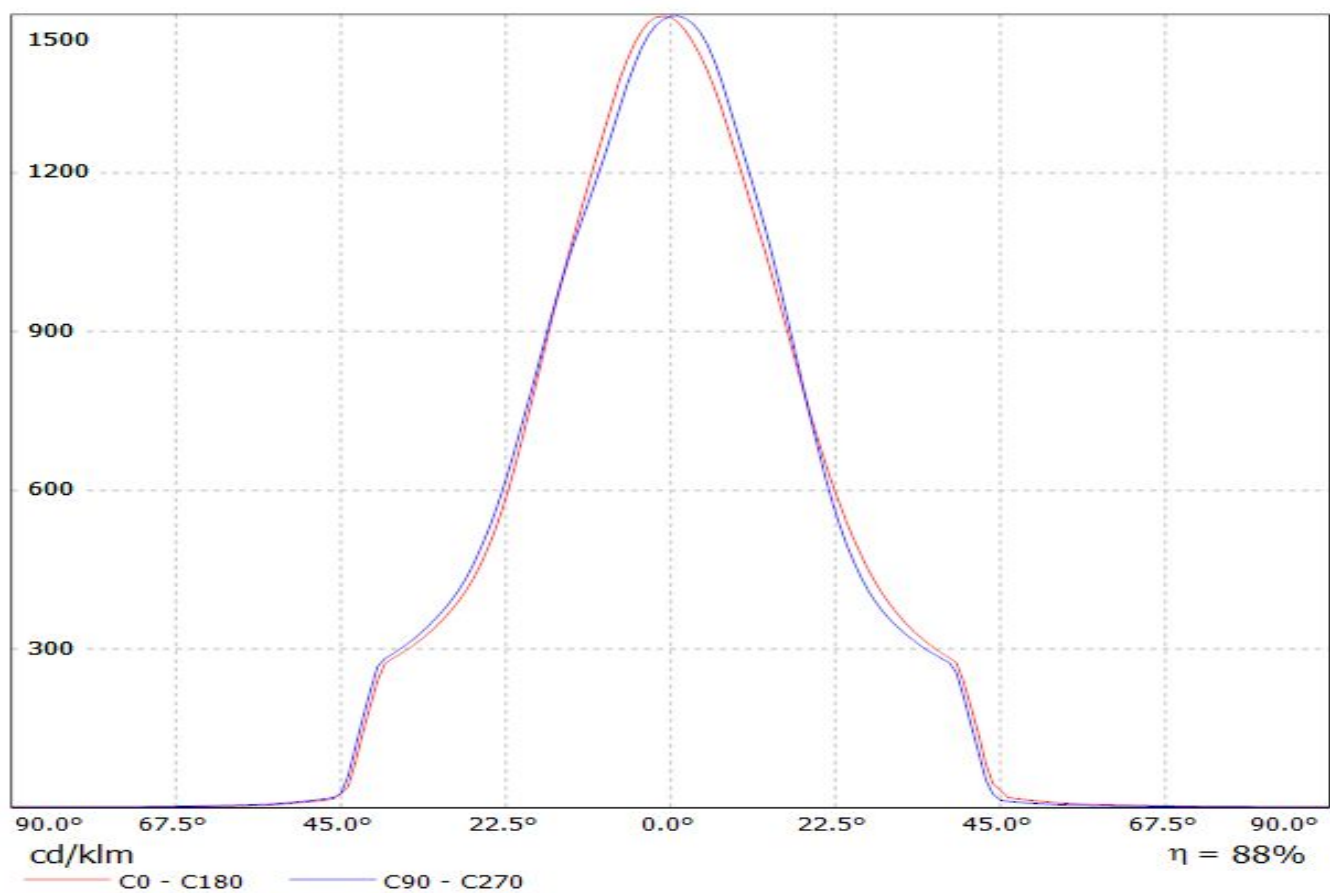

Luminaire: LEDiL Oy CN12488\_MIRELLA-50-W-PIN-DL\_(NS9x383) Eff. 82,5%  
Lamps: 1 x Nichia NS9x383 (105lm@250mA)

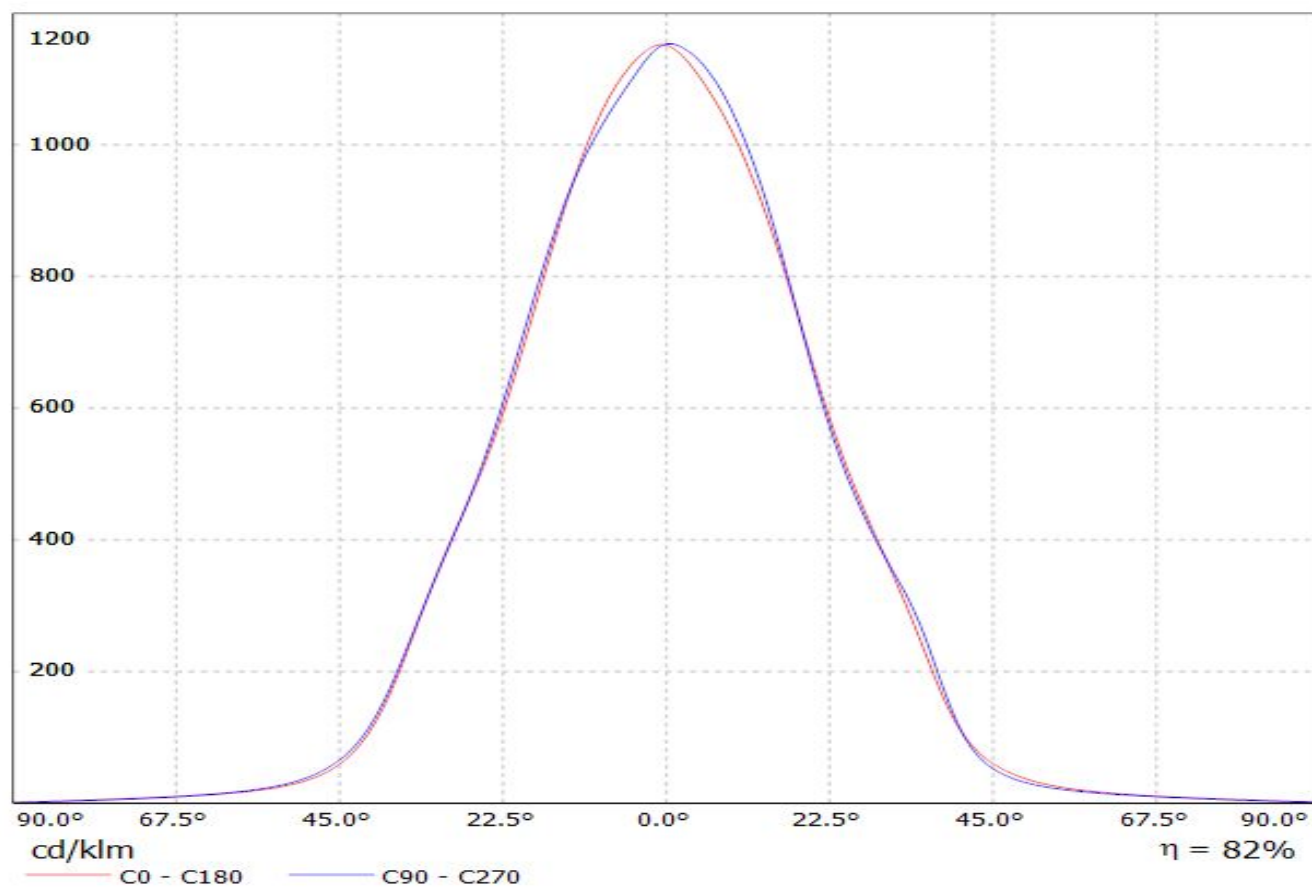

Lamps: 1 x Nichia NS9x383 (105lm@250mA)

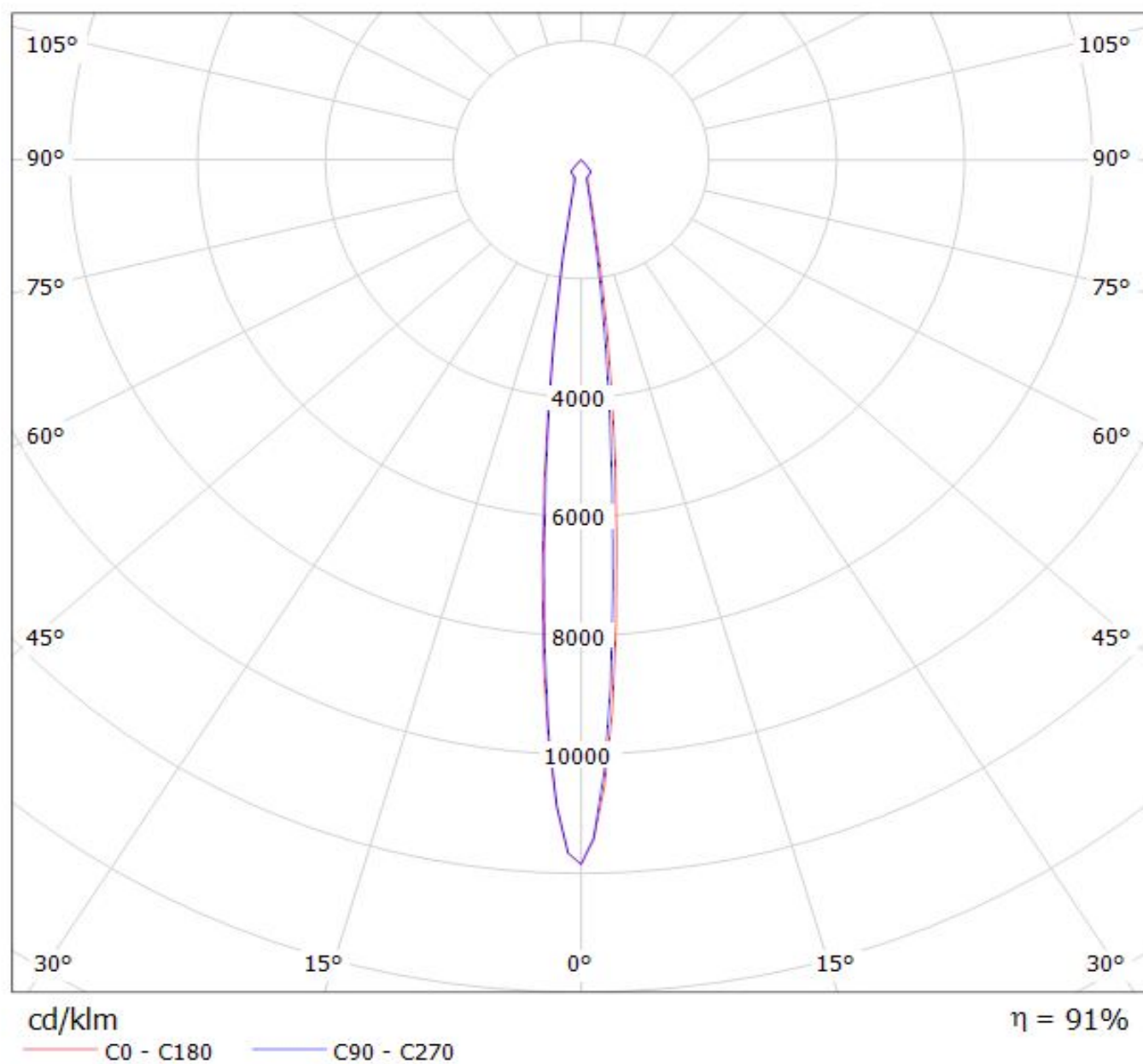

Luminaire: LEDiL Oy CN12486\_MIRELLA-50-S-PIN-DL Eff. 85,1%  
Lamps: 1 x Nichia NS9x383 (105lm@250mA)

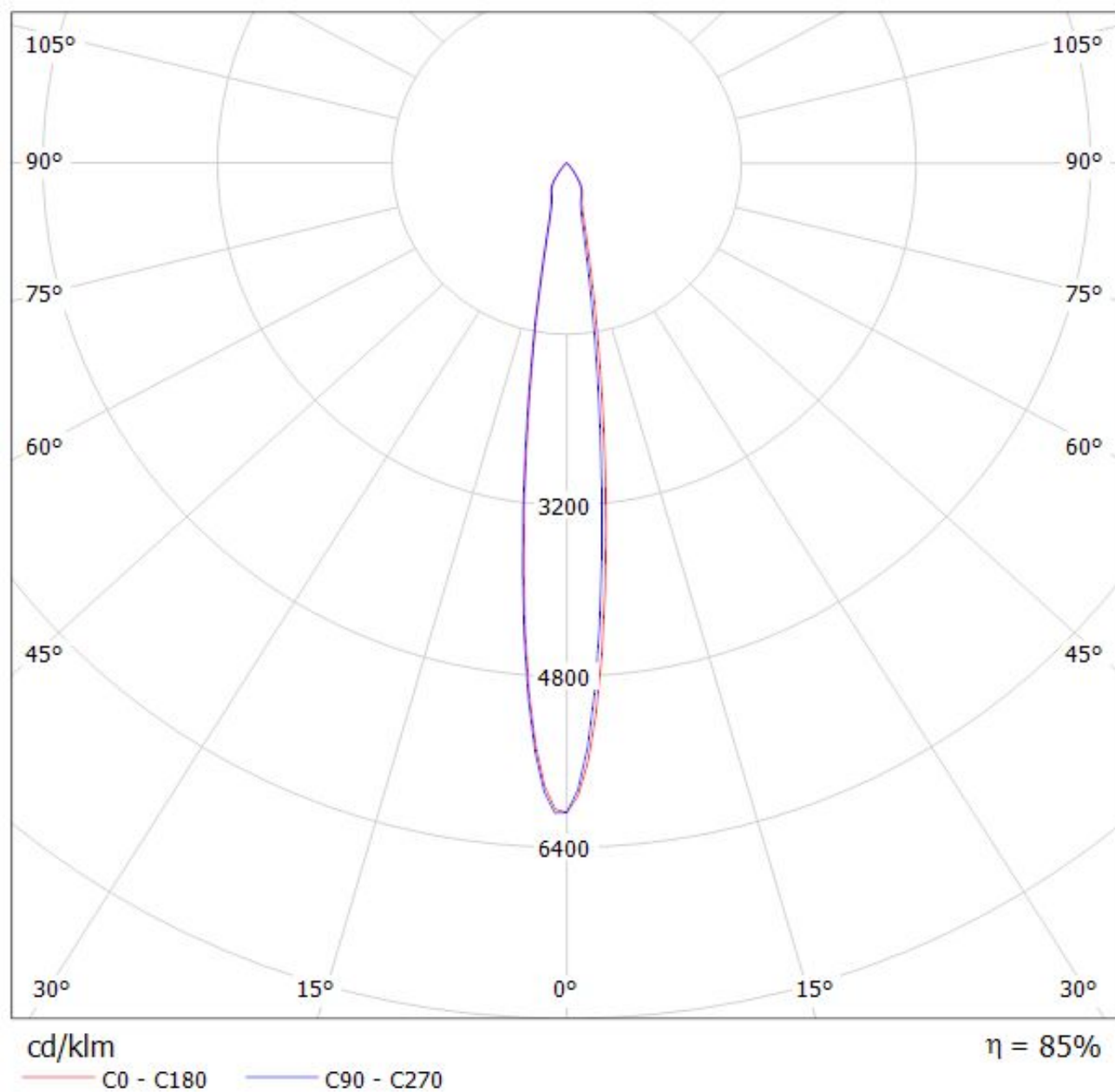

Luminaire: LEDiL Oy C12481\_MIRELLA-50-M-PIN\_(NS9x383) Eff. 88,3%  
Lamps: 1 x Nichia NS9x383 (105lm@250mA)

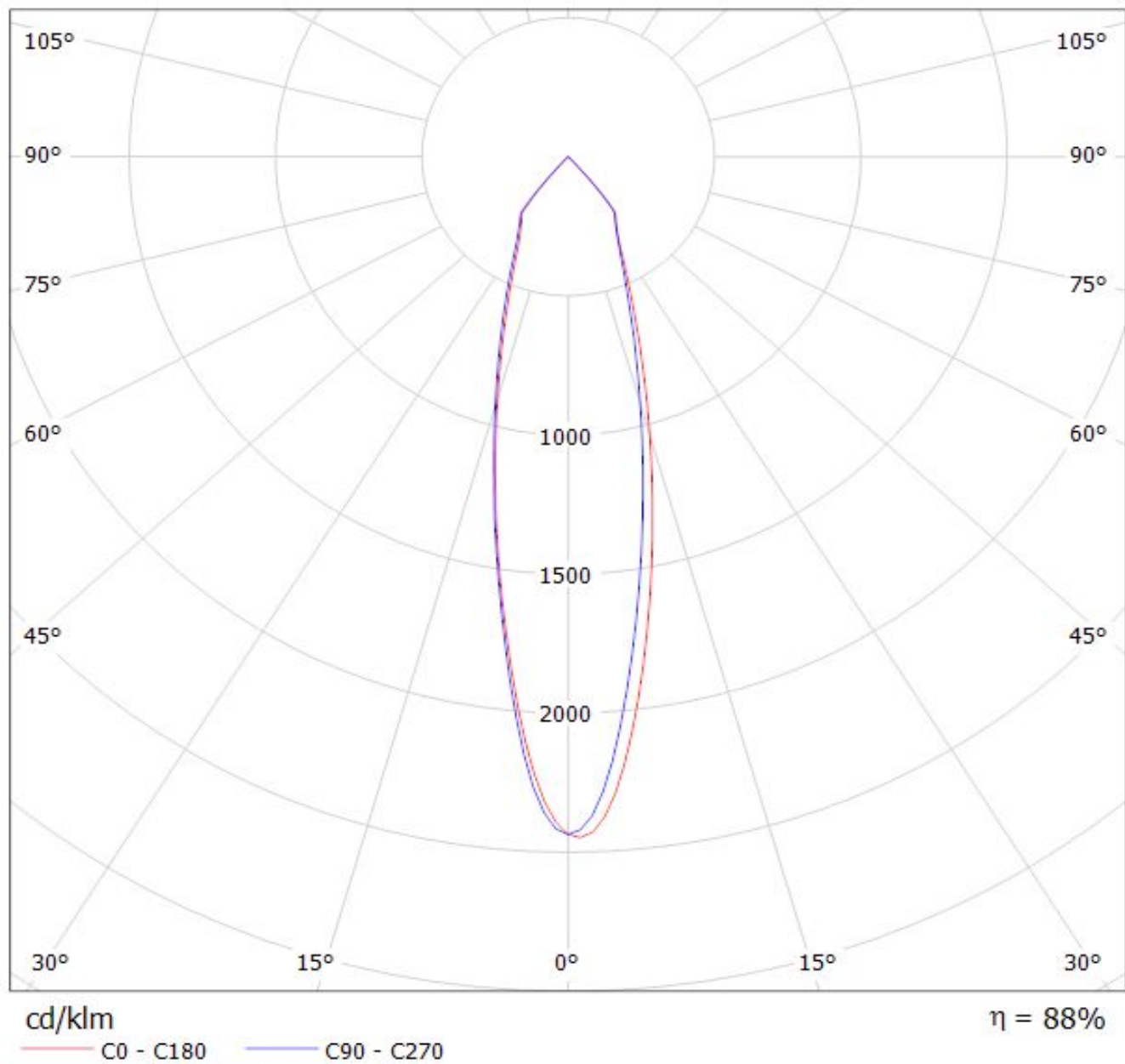

Luminaire: LEDiL Oy CN12487\_MIRELLA-50-M-PIN-DL\_(NS9x383) Eff. 82,5%  
Lamps: 1 x Nichia NS9x383 (105lm@250mA)

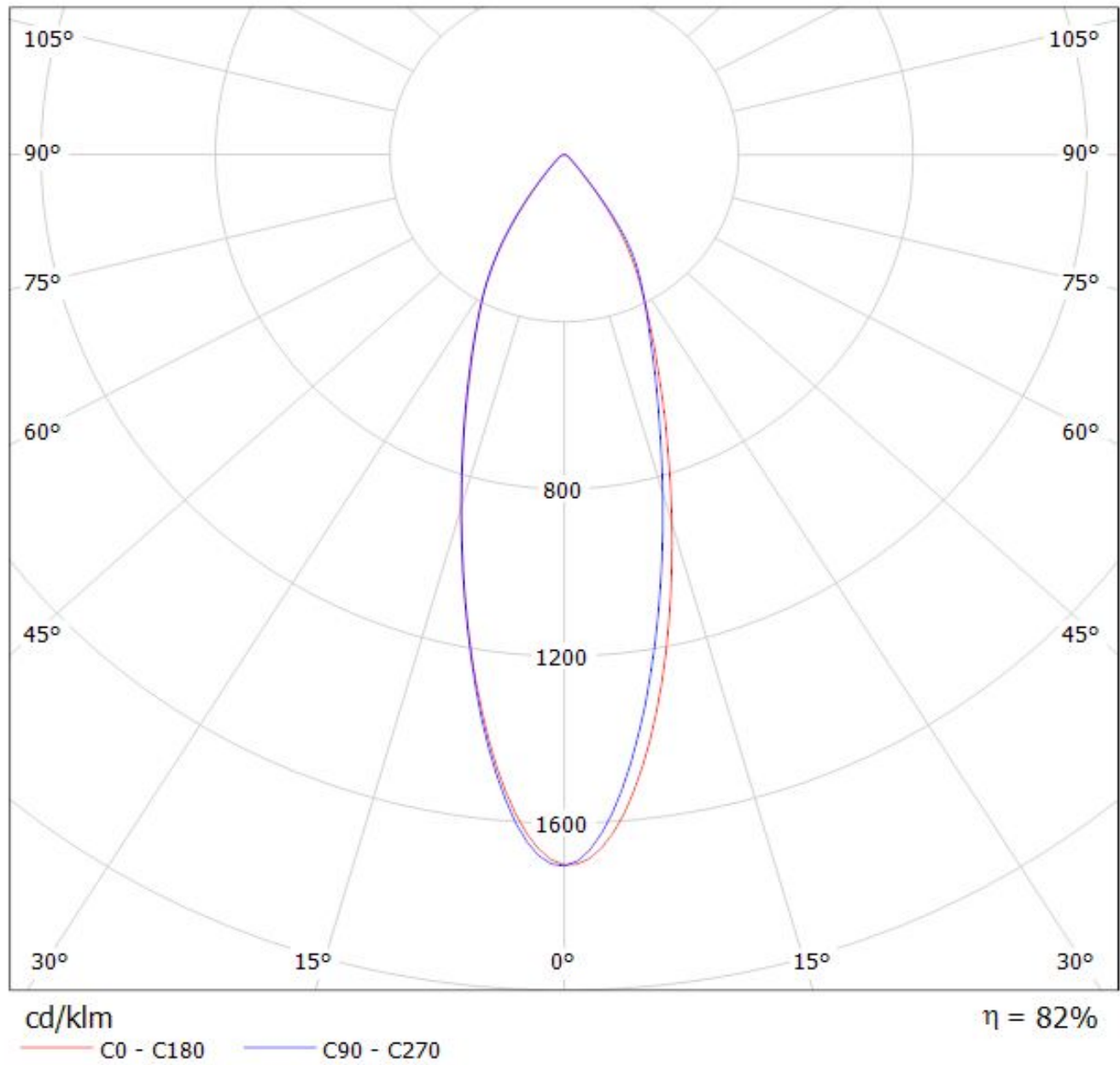

Luminaire: LEDiL Oy C12482\_MIRELLA-50-W-PIN\_(NS9x383) Eff. 88,5%  
Lamps: 1 x Nichia NS9x383 (105lm@250mA)

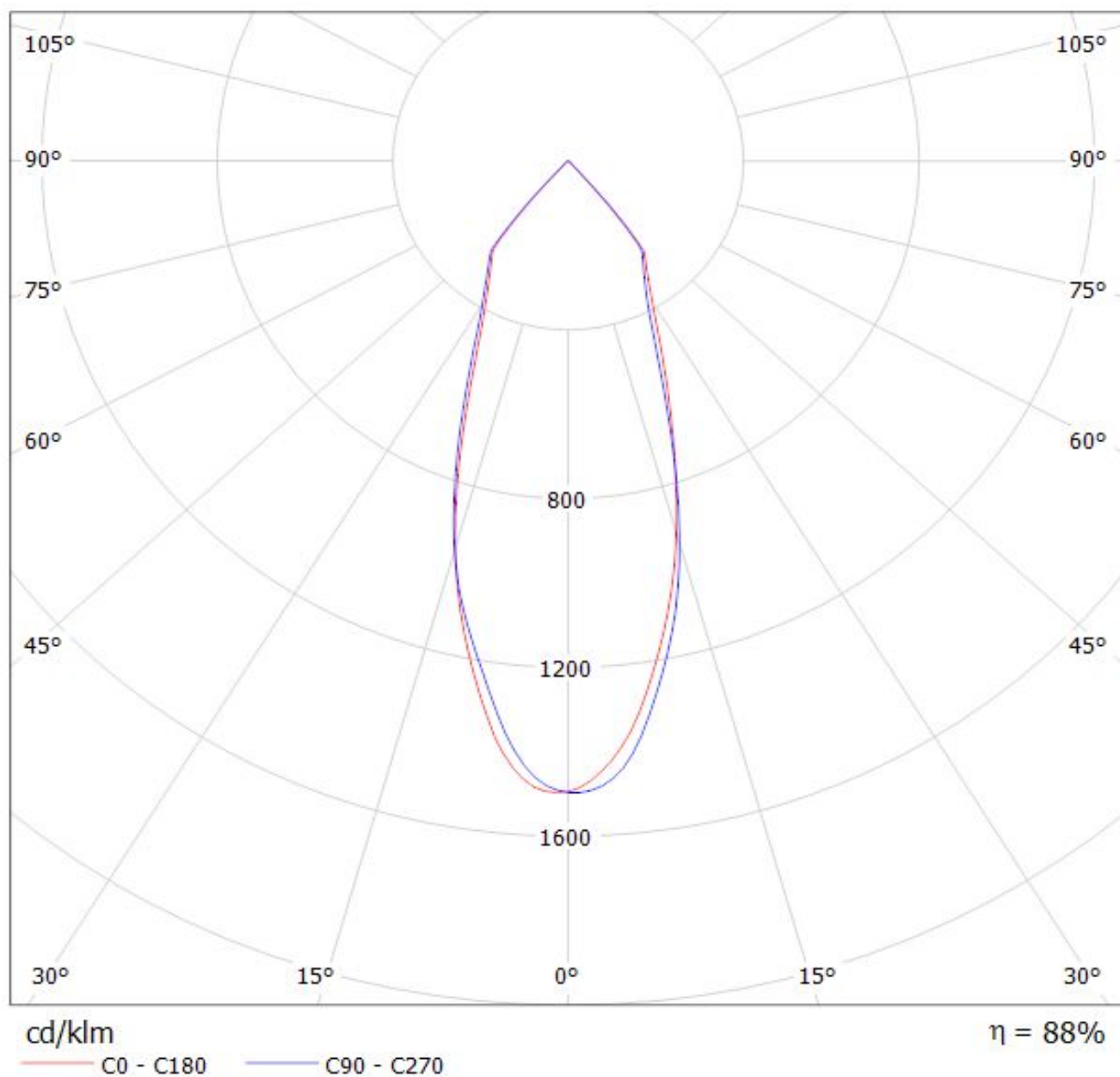



Luminaire: LEDiL Oy CN12488\_MIRELLA-50-W-PIN-DL\_(NS9x383) Eff. 82,5%  
Lamps: 1 x Nichia NS9x383 (105lm@250mA)

